



PROJECT WORK, ELEVATED

FORTE

DOOR STYLES

To best illustrate the profiles, each door is shown in Maple finished in Natural. The available wood types and price columns are listed below the photo, in the third row of information.

KEY TO WOOD TYPES C Cherry | M Maple | O Oak



BAINBRIDGE
Available in these wood types:
C7 | M7 | O4
Drawer header is slab
Optional five-piece drawer header
Standard edge is **F**



BRIGHTON TRADITIONAL OVERLAY
Available in these wood types:
C2 | M2 | O1
Drawer header is slab
Standard edge is **L**



BRISTOL
Available in these wood types:
C2 | M2 | O1
Drawer header is slab
Optional five-piece drawer header
Standard edge is **L**



COMMERCE 
Available in these wood types:
C5 | M3 | O2
Drawer header is slab
Optional five-piece drawer header
Standard edge is **L**



RIDGEWAY
Available in these wood types:
C6 | M5 | O5
Drawer header is slab
Optional five-piece drawer header
Standard edge is **L**



ROSEBURG
Available in these wood types:
C3 | M2 | O2
Drawer header is slab
Optional five-piece drawer header
Standard edge is **L**



SOMERSET TRADITIONAL OVERLAY
Available in these wood types:
C2 | M2 | O1
Drawer header is slab
Standard edge is **F**



STRATFORD
Available in these wood types:
C3 | M2 | O1
Drawer header is slab
Optional five-piece drawer header
Standard edge is **F**



TEMPE
Available in these wood types:
C6 | M6 | O2
Drawer header is slab
Standard edge is **L**



TREMONT TRADITIONAL OVERLAY
Available in these wood types:
C6 | M6 | O2
Drawer header is slab
Standard edge is **F**



This kitchen was created with the Roseburg door style in Maple finished in Marshmallow Cream and in Cherry finished in Hazelnut. Shown with optional five-piece drawer headers.

CHERRY COLORS



NATURAL



TARRAGON 



BUTTERSCOTCH



PAPRIKA



RYE 



HAZELNUT

MAPLE COLORS

OAK COLORS

MAPLE COLORS

OAK COLORS



NATURAL



NATURAL



TARRAGON



BUTTERSCOTCH



PAPRIKA



PAPRIKA

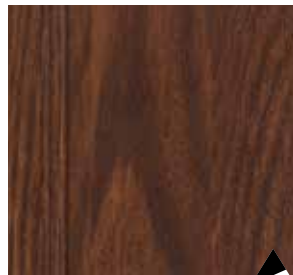

RYE



HAZELNUT

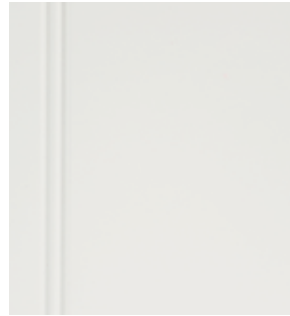

WHITE



WHITE

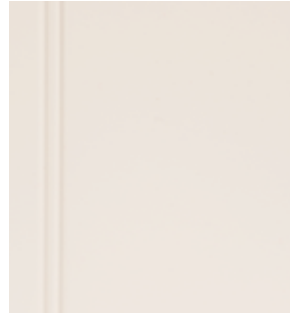

MARSHMALLOW CREAM



MARSHMALLOW CREAM



REPOSE GREY

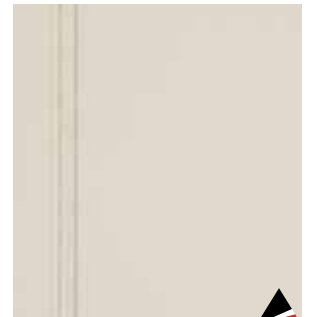

REPOSE GREY

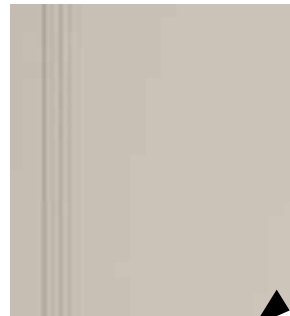

PORTABELLA

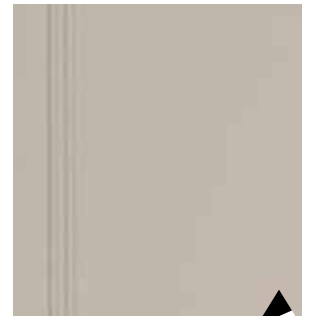

PORTABELLA



PEPPERCORN



PEPPERCORN

FORTE

Project work, elevated

Forte isn't a stripped down cabinet box. Forte retains all the good looks and quality warranted construction of Fieldstone Cabinetry in a collection of popular doors and finishes. These are the looks homeowners want for their new homes, along with soft close doors and drawers as standard, at a price point that offers unbeatable value.

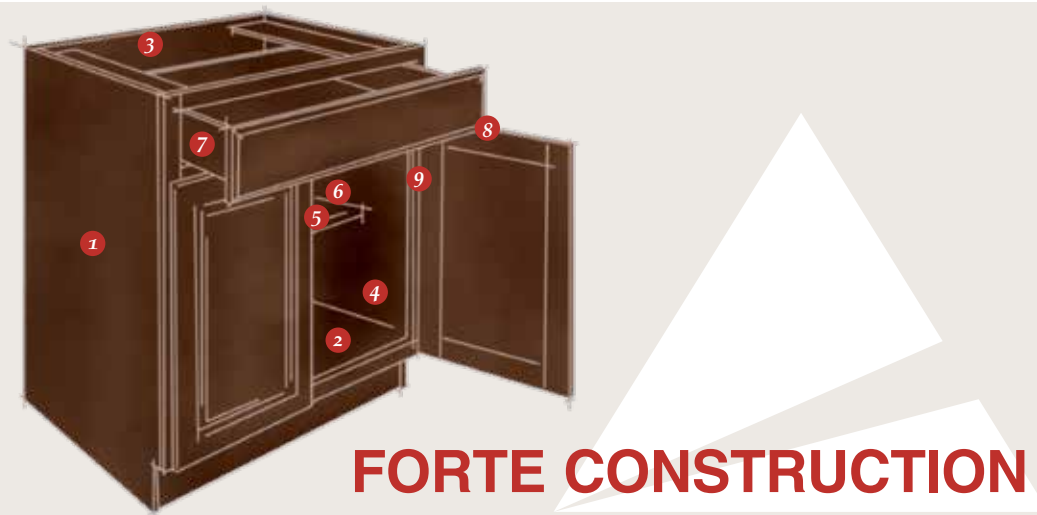
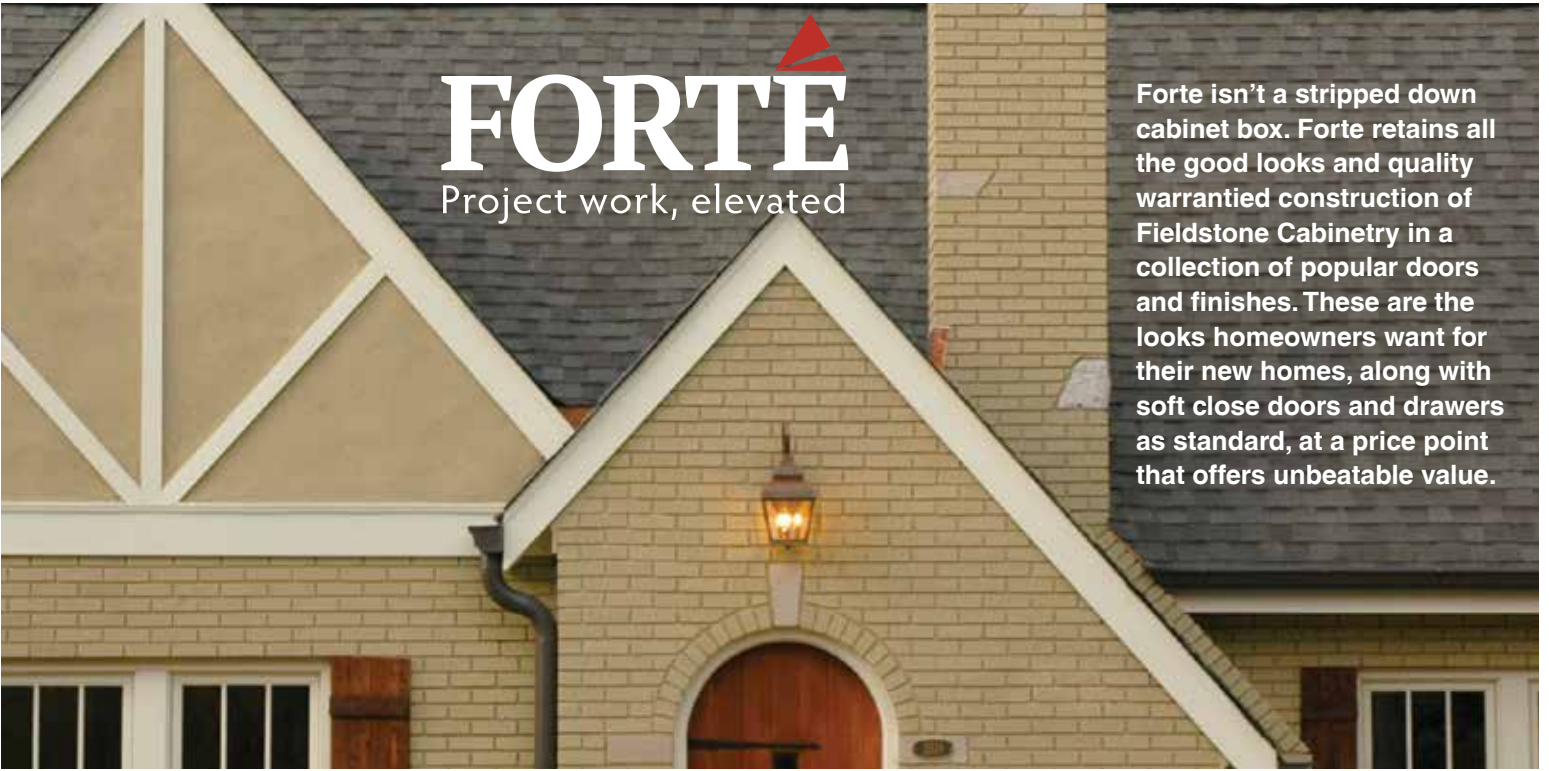

FORTE CONSTRUCTION

1.	End (side) Panels <i>option</i> <i>option</i>	1/2" hardwood plywood veneer core-unfinished Finished ends Furniture ends
2.	Tops & Bottoms <i>option</i>	7/16" engineered wood 1/2" hardwood plywood veneer core
3.	Back Panels	1/4" hardwood plywood
4.	Interiors <i>option</i>	Natural birch melamine Stained matching veneer on standard open shelf cabinets or glass door cabinets
5.	Shelves <i>option</i>	3/4" engineered wood 3/4" hardwood plywood veneer core
6.	Base Cabinet Shelves	Two thirds deep
7.	Drawers & Rolls Trays Glides	5/8" hardwood birch, dovetail joinery Soft close, full extension, undermount
8.	Door/Header Edge	Standard edge only
9.	Door Hinges	Adjustable, soft close
	Cycle Ship	Standard
	Warranty	Limited Lifetime
	Minimum Order	10 Cabinets

FIELDSTONE[®] CABINETS

600 East 48th Street North • Sioux Falls, SD 57104
www.fieldstonecabinetry.com

This brochure is item #3111 and is called the "Forte" flier.
© 2019 Fieldstone Cabinetry

- www.facebook.com/fieldstonecabinetry
- www.instagram.com/fieldstonecabinetry/
- www.pinterest.com/lovefieldstone/
- www.houzz.com/pro/fieldstonecabinetry/fieldstone-cabinetry
- www.youtube.com/user/CabinetryFieldstone
- www.linkedin.com/company/fieldstone-cabinetry
- Send questions to inquirefs@fieldstonecabinetry.com
- At www.fieldstonecabinetry.com, sign up for our newsletter highlighting trends, new products, and before-and-after transformations.



American Craftsmanship
Manufactured in Sioux Falls, South Dakota from domestic and global components.



Fieldstone Cabinetry is a Norcraft Companies brand. Norcraft Companies is part of the MasterBrand Cabinets Family.



Fieldstone Cabinetry is CARB II compliant and ESP certified. Kitchen Cabinet Manufacturers Association Environmental Stewardship Program. All products impact the environment. For ESP program criteria, visit kcma.org.

This brochure was printed in June 2019. Accuracy of all reprinted color is subject to printing limitations. Please bear in mind that variation is inherent in wood, and actual finishes may differ substantially from what you see here. As we continually seek to improve materials and production methods, Fieldstone Cabinetry reserves the right to change specifications, offerings or designs without notice.

SHOWN ON THE COVER This kitchen was created with the Bristol door style in Oak finished in Marshmallow Cream. The island was created with the Bristol door style in Oak finished in Peppercorn. Shown with optional five-piece drawer headers.